

The Original
PLASTIC WELDERS
Made in the U.S.A



Kamweld The Best in Plastic Welding



Kamweld
STAINLESS STEEL
Welding Products



44-AWC

300 and 400, or 700 watt combination for model 44-AW

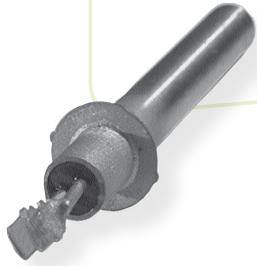

HSC

600, 750, and 900 watt for model 43-HS



RWC

350 watt for model 46-RW and 600 watt for model 47-RW



HTC & HSC

350 and 450 watt for model 41-HT and model 42-TM

Kamweld Industries, Inc.

Kamweld Industries, Inc. is a leading provider of plastic welding products, industrial hot air guns, plastic sheet bending devices and accessories. For nearly 50 years, the Kamweld name has stood for superior products, rugged durability and highly competitive prices. All of our products are developed, manufactured, tested and packaged within the USA, resulting in consistent quality and rapid turnaround time.



KHAG

The KAMWELD Hot Air Gun is supplied complete with an air regulator and pressure gauge, a 2" long, 5/8" diameter stainless steel flanged round tip with check-nut and 5 ft of insulated cable. A stainless steel wrap-around mounting bracket permits permanent mounting to existing equipment, and the gun may be grounded through the mounting bracket. Two models available. Both models are designed for use with 115 volts AC, but they can be supplied for a 230 volt system.



KHD

The KAMWELD Heating Device is used for bending plastic sheets of different widths and lengths. This bending device heats thermoplastic sheets in order to make straight-line bends that are necessary when fabricating items such as hoods, ducts, tanks, displays, signs and many other items. KHD consists of two rectangular aluminum heating bars, two control switches for adjusting the temperature and two aluminum base units. Each heating bar contains an electric heating element that provides uniform heat. Four sizes are available: 28", 54", 96" & 144".





41-HT

For tack or hand welding with round tips at speeds of approximately 12 inches per minute. Ideally suited for back welding of pipe, short radii or hard-to-reach areas. The standard stainless steel heating element for this welder is rated at 350 watts. An optional 450 watt element is available for high-speed welding using 1/8" or 5/32" rod. Includes: an air regulator, pressure gauge and complete operating and maintenance instructions. Tips and accessories must be ordered separately. Operates on shop air or inert gas.



42-TM

Trainer and maintenance kit which includes Model 41-HT along with a 350 watt stainless steel element, air regulator and pressure gauge, KR round tip, KT tacker tip, aluminum welder stand and a steel carrying case. This model contains everything needed for training as well as for fabricating and maintenance. Operates on shop air or inert gas.



43-HS

A heavy-duty welder for medium and high-speed welding of thermoplastics with welding speeds up to 60" per minute, depending on the diameter of the rod. The standard stainless steel heating element is rated at 600 watts. This lightweight hot gas welder can be used with all types of weldable thermoplastics having a minimum thickness of 1/16". Elements available in 750 or 900 watt ratings. Operates on shop air or inert gas. Includes an air regulator, pressure gauge and complete operating and maintenance instructions. Tips and accessories must be ordered separately. Operates on shop air or inert gas.



44-AW

The model 44-AW is the most light-weight and versatile plastic welder available. It can be used both in the shop and in the field for any type of welding ranging from tack welding to high-speed welding. Operates on shop air or inert gas. The variable power setting offers versatility in welding a variety of thermoplastics.



Model 46 & 47-RW

Self-contained, portable units with built-in air compressors in steel carrying cases. These welders cannot be connected to an inert gas supply. Use outdoors or in the shop with thermoplastics 1/16" or thicker. Have a low-to-high heat selector. Requires 120 volts AC. Model 46-RW is a light-duty welder with a 350 watt heating element for fabricating, maintenance or common repair. Model 47-RW is a heavy-duty welder with a 600 watt heating element. Both kits include a KR round tip.

Visit Kamweld.com to place your order today!

You can also go to Kamweld.com for great information about our plastic welding products, industrial hot air guns, plastic sheet bending devices, accessories and replacement parts.



Kamweld
STAINLESS STEEL
Tools & Tips

KS-2

For Type I and II PVC, 3/16" round rod



KST-1

For triangular PVC rod, equivalent to 1/8"



KT

Tacker Tip for hand welding



KS-1-8

For Type I and II PVC, 1/8" round rod



KS-2B

For low-density polyethylene, 3/16" round rod



KST-1A

For triangular polypropylene rod, equivalent to 1/8"



KF-1

Flat Tip, 5/8" to 3/4" wide for hand welding



KS-1-8-A

For polypropylene, 1/8" round rod



KS-2C

For polypropylene, high-density polyethylene and other high-temperature thermoplastics, 3/16" round rod



KST-2

For triangular PVC rod, equivalent to 3/16"



KF-2

Flat Tip, 1" wide for hand welding



KS-1

For Type I and II PVC, 5/32" round rod



KS-3

Flat and corner strip for tank lining, 5/8" to 3/4", plasticized PVC



KST-2C

For triangular polypropylene rod, equivalent to 3/16"



KV-1

Also known as the "V" Tip, 5/8" to 3/4" wide for hand welding



KS-1-OLD

Longer version of KS-1



KS-4A

Flat and corner strip for tank lining, 1", plasticized PVC



KST-3

For triangular PVC rod, equivalent to 1/4"



KV-2

"V" Tip, 1" wide for hand welding



KS-1B

For low-density polyethylene, 5/32" round rod



KS-6

For Type I and II PVC, 1/4" round rod



KST-3C

For triangular polypropylene rod, equivalent to 1/4"



KRL

Round Tip, extra long for hard-to-reach areas for hand welding



KS-1C

For polypropylene, high-density polyethylene and other high-temperature thermoplastics, 5/32" round rod



KST-6C

For polypropylene, high-density polyethylene and other high-temperature thermoplastics, 1/4" round rod



KR

Round Tip for hand welding



Kamweld Industries, Inc.

P.O. Box 610183
Newton, MA 02461
617-558-7500
www.kamweld.com

